

FLAT ROOF TRIM CORNER CUTTING GUIDE

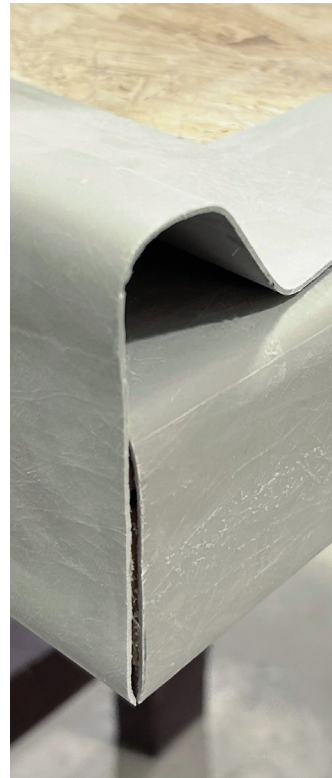

Trim Components

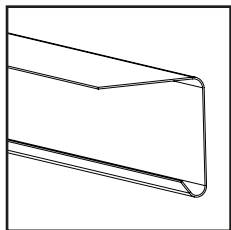

Flat Edge Drip

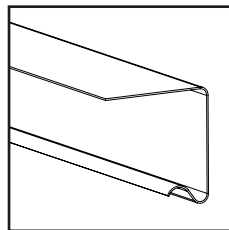

Flat Edge Drip With Return

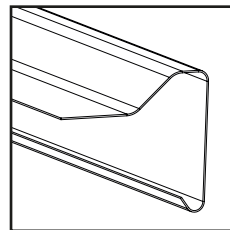

Raised Edge Kerb

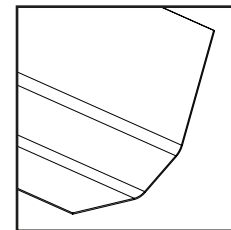

Wall Fillet

Notes

When marking trims for cutting, ensure that all faces required to be vertical when installed are vertical when marked.

Avoid drawing cut lines. Start the cut where required and cut straight to the end mark.

These principles can be applied to all cutting requirements.

External Corners - Flat Edge Drip

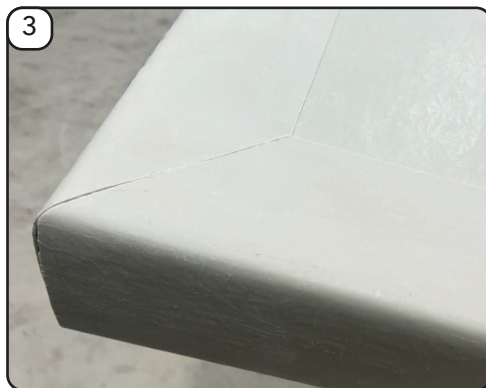
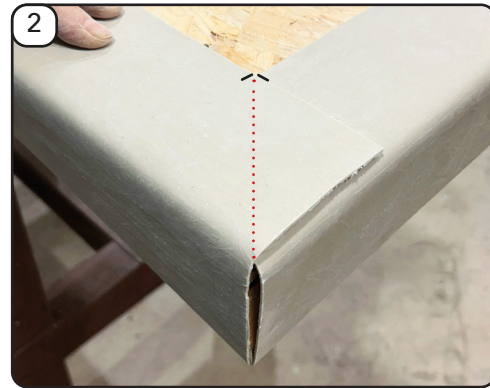

To establish the cutting line, align both trims to the corner. With one trim overlapping, mark both where they overlap.

Cut both trims from the mark to the corner at the end of the trim. **[2]**

Position and fix the cut trims to create the external mitred joint. **[3]**

External Corners - Raised Edge Kerb

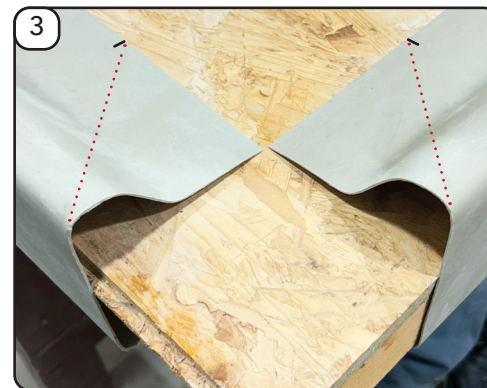
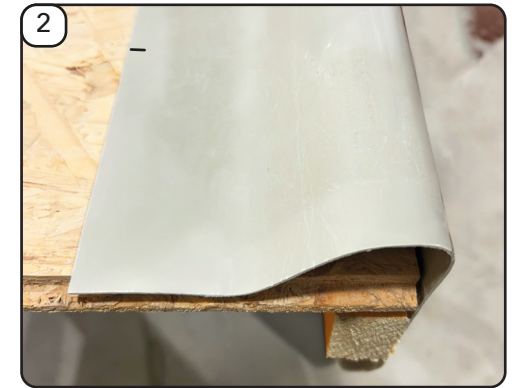
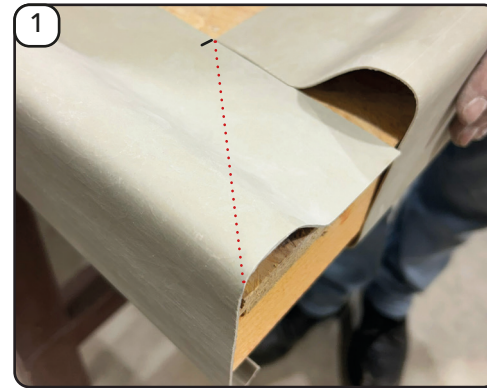

To establish the cutting line, align both trims to the corner. **[1]**

Mark the edge of the trims at the intersecting point on both trims, using the opposing trim as a guide. **[2&3]**

Cut from the marked points to the corner or from the corner to the mark. Cut away the bottom drip edge to the same angle. **[3]**

Position and fix the cut trims to create the external mitred joint. **[4]**

External Corners - Raised Edge Kerb to Flat Edge Drip

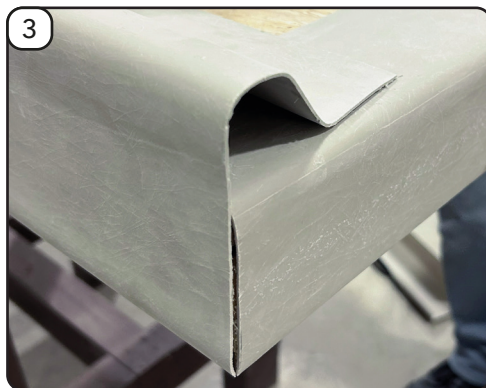
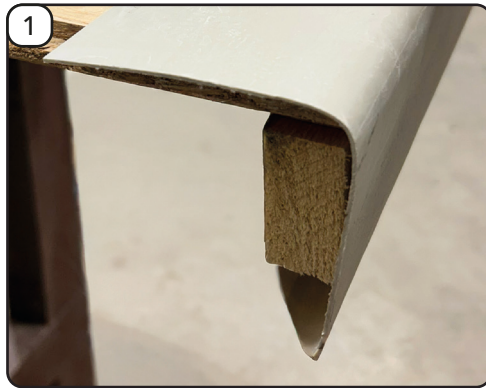

Position the Flat Edge Drip trim to the corner and cut the bottom edge drip at 45° to create a mitre. **[1]**

Position the Raised Edge Kerb trim to the corner and cut the bottom edge drip at 45° to create a mitre. **[2]**

Cut the edge of the horizontal flange on the Raised Edge Kerb trim back short of the radius on the drip edge trim below. **[3]**

Position and fix the trims to form the corner. **[3]**

External Corners - Wall Fillet

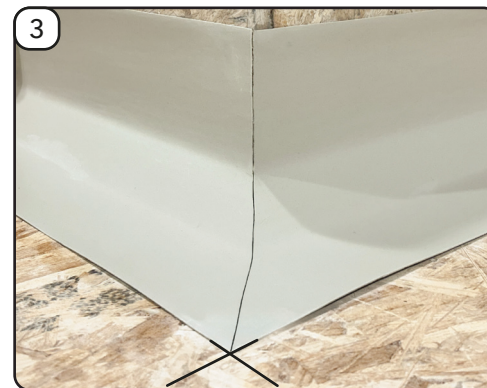
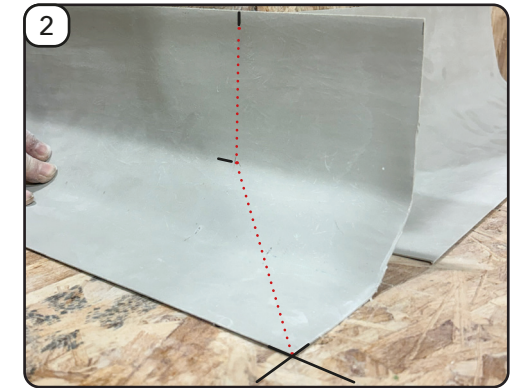

To establish the cutting line, position the trim extending past the external corner and mark the edge of the trim on the roof. **[1]**

Repeat this on the other side of the corner. Where the lines intersect is the end position for the two trims.

With each trim in position, mark the top of the vertical flange at the corner behind. Make a vertical cut in the vertical flange down to the first bend. **[2]**

Make a straight line cut from the bottom of the first cut to the end corner of the trim. This second cut is easier if made on the reverse. **[3]**

Internal Corners - Flat Edge Drip

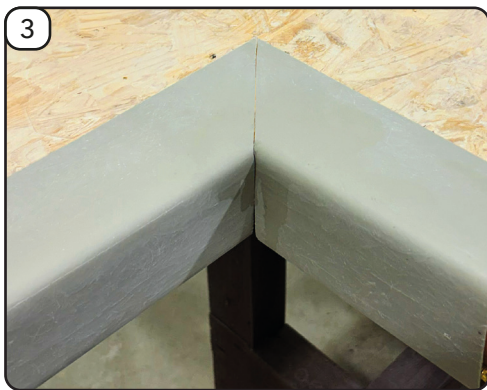
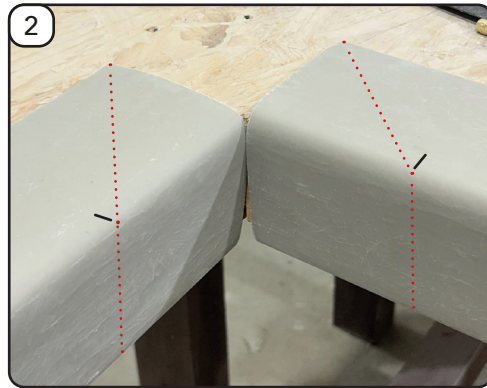
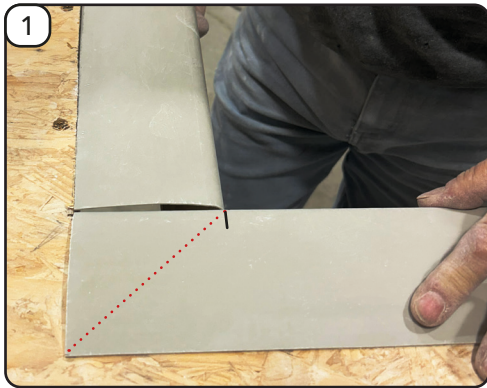

- To establish the cutting line, align both trims squarely to the corner. **[1]**
- Mark the corner and the intersecting point on one trim. **[1]**
- Repeat for the opposing trim.
- On both trims cut vertically down from the intersecting mark. **[2]**
- Cut to end corner of trim.
- Cut a matching mitre to the drip on the bottom edge of both trims and fix. **[3]**

Internal Corners - Raised Edge Kerb

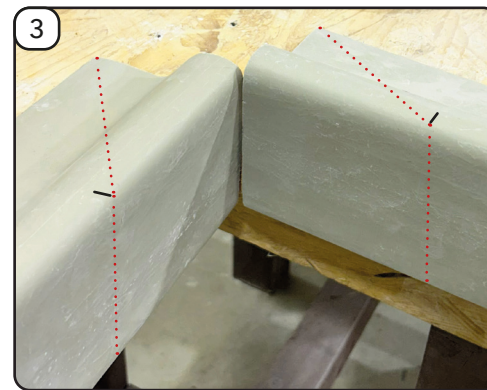
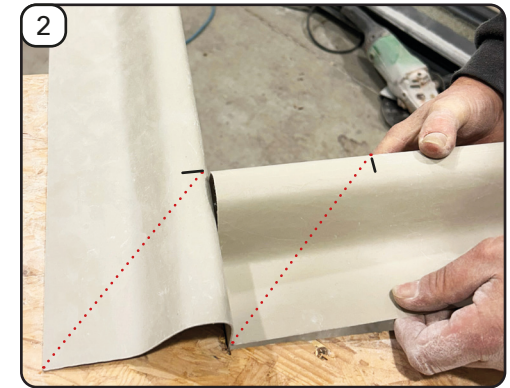
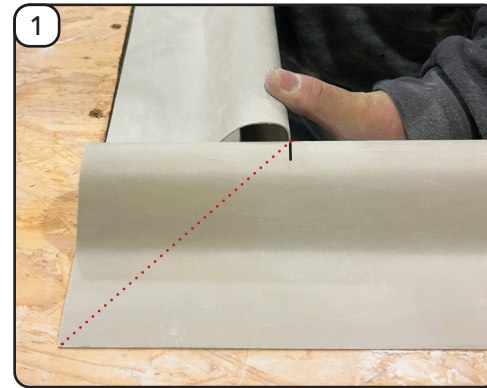

- To establish the cutting line, align both trims to the corner. **[1]**
- Mark the intersecting point on the face of one trim and then repeat for the opposing trim. **[1&2]**
- On both parts cut the face vertically down from the intersecting mark, cut from the marks to the end of the trims, and butt together to create the mitred joint. **[3]**

Internal Corners - Wall Fillet

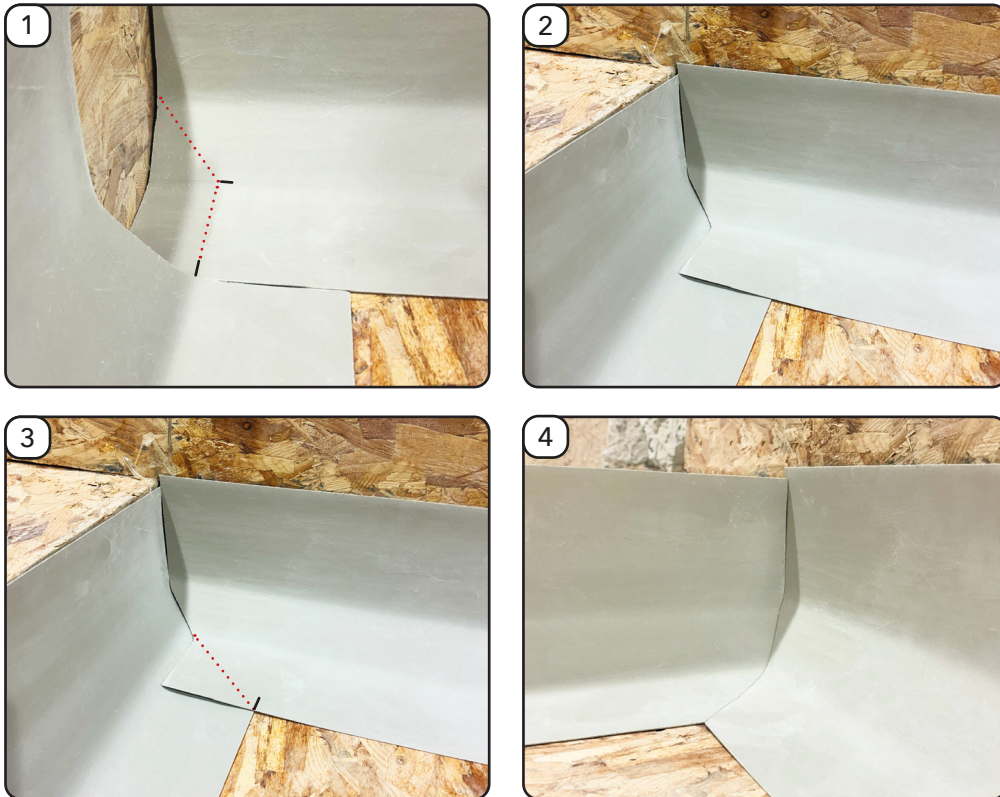

To establish the cutting line, align both trims to the internal corner.
 On one trim only, mark the front edge position and cut square to the first bend. **[1]**
 Cut from the edge of the trim on the second bend to the end of the first cut. **[1]**
 Fix the trim in position over the top of the uncut trim. **[2]**
 For a mitred joint appearance continue the cut line to where the bottom edge of the trims meet. **[3&4]**

Wall Fillet to Raised Edge Kerb

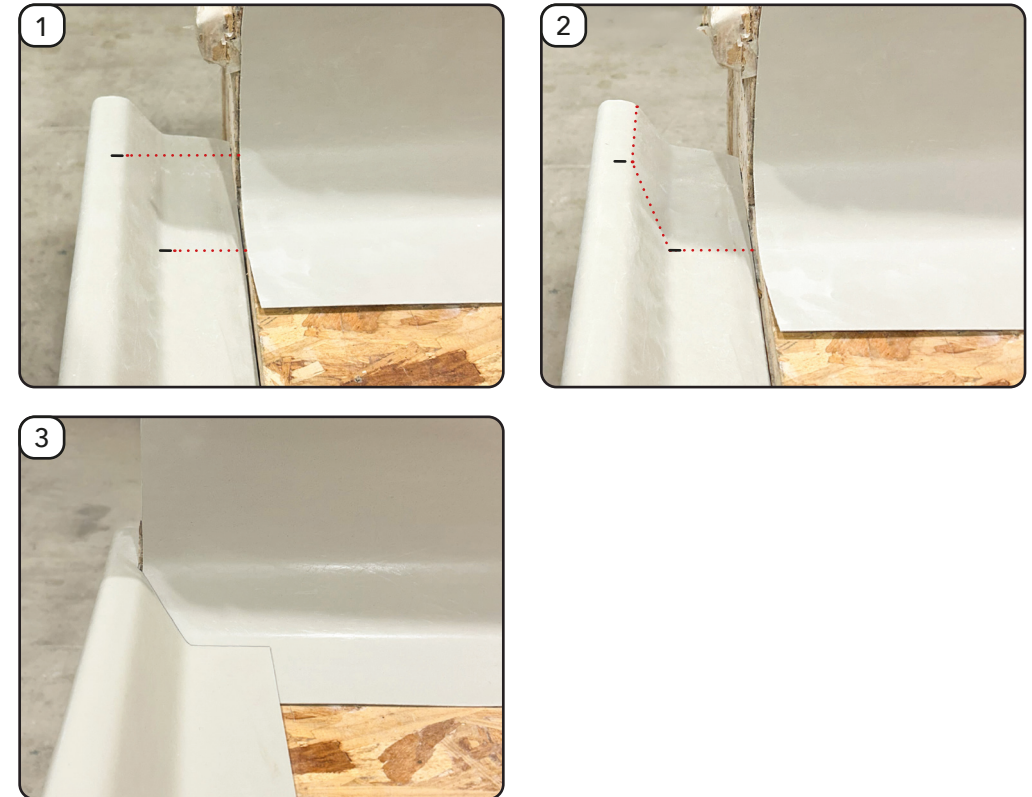

With the Wall Fillet trim in position, mark the lines of the angle fillet on the Raised Edge Kerb. **[1]**
 Cut from the end of the Raised Edge Kerb parallel to the trim up to the first mark. **[2]**
 Cut from the edge of the Raised Edge Trim square to the second mark. **[2]**
 Cut between the ends of the cuts to remove section, position and fix the trims to form the corner. **[3]**